

THIS DRAWING IS UNPUBLISHED. RELEASED FOR PUBLICATION  
 © COPYRIGHT BY TYCO ELECTRONICS CORPORATION. ALL RIGHTS RESERVED.

LOC	DIST	REVISIONS 変更			
P	LTR	DESCRIPTION	DATE	DWN	APVD
	H	REVISED ECR-07-011428	13JUN'07	J.S	S.M
	H1	REV PER ECO-10-000443	13JAN10	KK	AEG

ロケーション・マーク  
LOCATION MARK

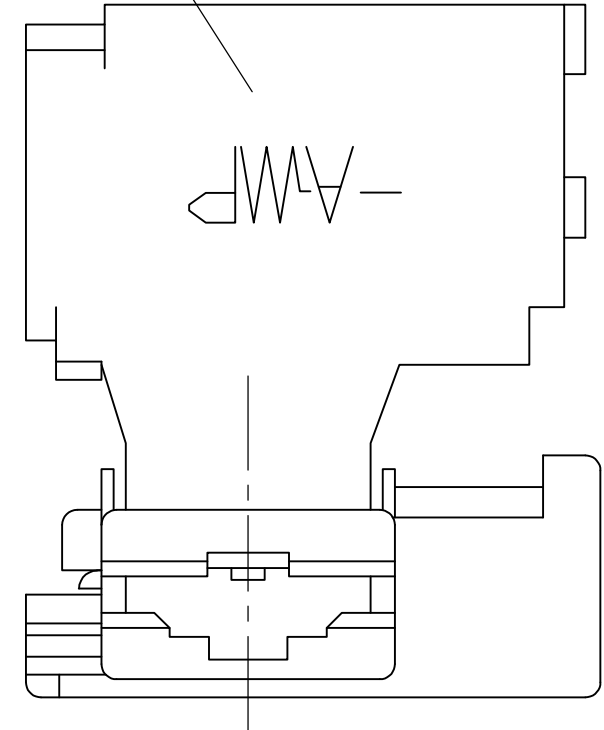
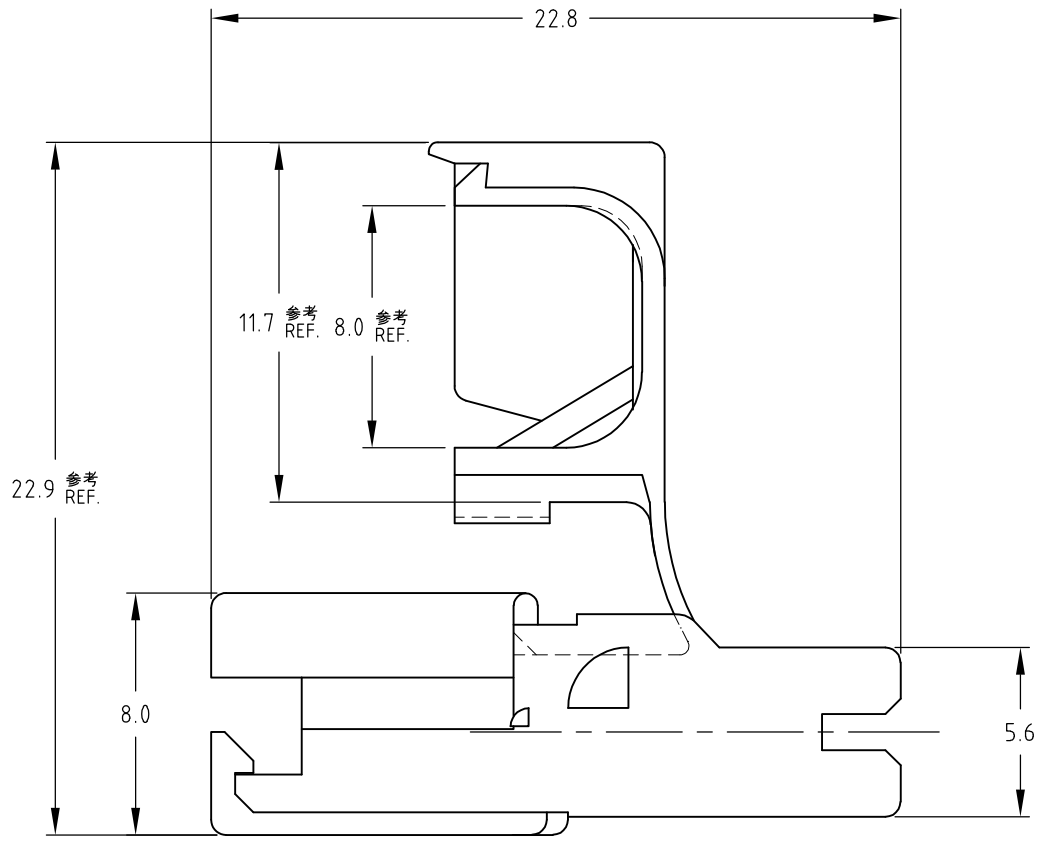
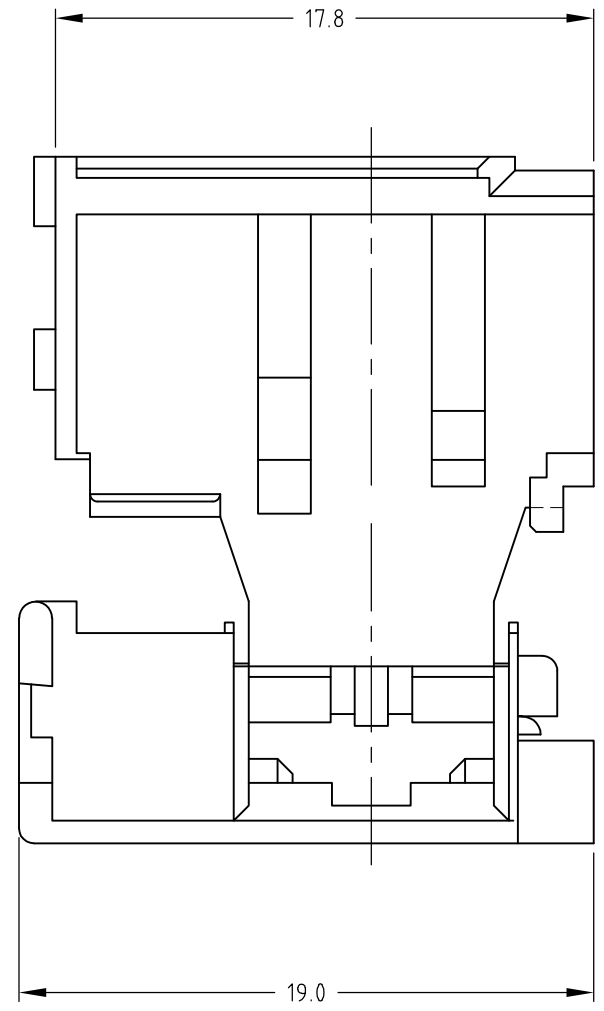

注；  
 1. 適用コンタクト；  
 型番：172761,172782,172763  
 2. 取扱説明書；411-5212

NOTES ;  
 1. APPLICABLE CONTACT  
 PARTS NUMBER : 172761,172762,172763  
 2. INSTRUCTION SHEET : 411-5212  
 △ OBSOLETE PARTS: OBSOLETE CIS STREAMLINING  
 PER D.RENAUD/D.SINISI

△ OBSOLETE	1-172469-3	黄 YELLOW	6/6ナイロン 6/6 NYLON	UL94V-0
	1-172469-2	青 BLUE		UL94V-0
	1-172469-1	自然色 NATURAL		UL94V-0
	172469-8	黒 BLACK		UL94V-2
△ OBSOLETE	172469-7	赤 RED		UL94V-2
	172469-4	緑 GREEN		UL94V-2
	172469-3	黄 YELLOW		UL94V-2
	172469-2	青 BLUE		UL94V-2
	172469-1	自然色 NATURAL		UL94V-2
型番	PART NUMBER	色調 COLOR	材料 MATERIAL	

THIS DRAWING IS A CONTROLLED DOCUMENT.		DWN M.SUZUKI 17.APR.'02	Tyco Electronics Tyco Electronics AMP K.K. Kawasaki, Japan												
DIMENSIONS: 単位： 耗 mm		CHK M.SHINDO 17.APR.'02	NAME 名称 250 SERIES FLAG POSITIVE LOCK MARK-II HOUSING												
TOLERANCES UNLESS OTHERWISE SPECIFIED: 一般公差		APVD M.SHINDO 17.APR.'02	PRODUCT SPEC 製品規格 108-5162												
<table border="0"> <tr><td>0 PLC</td><td>± 0.4</td></tr> <tr><td>1 PLC</td><td>± -</td></tr> <tr><td>2 PLC</td><td>± -</td></tr> <tr><td>3 PLC</td><td>± -</td></tr> <tr><td>4 PLC</td><td>± -</td></tr> <tr><td>ANGLES</td><td>± 3'</td></tr> </table>		0 PLC	± 0.4	1 PLC	± -	2 PLC	± -	3 PLC	± -	4 PLC	± -	ANGLES	± 3'	APPLICATION SPEC 取付適用規格	
0 PLC	± 0.4														
1 PLC	± -														
2 PLC	± -														
3 PLC	± -														
4 PLC	± -														
ANGLES	± 3'														
MATERIAL 材料 SEE TABLE	FINISH 仕上	WEIGHT	SIZE A3	CAGE CODE 00779											
CUSTOMER DRAWING			DRAWING NO 番号 G-172469	RESTRICTED TO -											
			SCALE 尺度 4:1	SHEET 1 OF 1											
			REV H1												