

SECTION:A-A

Materials

- Housing: Thermoplastic (LCP + GF)
- Contact: Brass

Plating

- Contact: Gold Plating

Electrical

- Voltage Rating: 30V
- Current Rating: 1.5A
- Contact Resistance Terminal: 30mΩ Max
- Dielectric Withstanding Voltage: 500V AC
- Insulation Resistance: 1,000mΩ Min

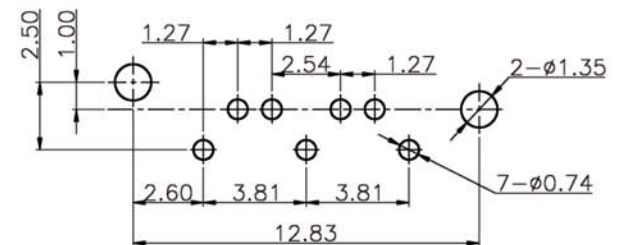

RECOMMENDED PCB LAYOUT

⊗ = Assmann Logo



ITEM NO

A-SATA/7-M-BO-C-02-03-R

TITLE SATA Connector 7 Pin, B-Male, DIP 180° Type,
15μ" Gold Plating, BLACK

ASSMANN
Electronics, Inc.

1840 W. Drake Drive, Suite 101 - Tempe, AZ 85283

Toll Free: 1-877-277-6266 Email: info@usa-assmann.com

THIS DRAWING IS UNPUBLISHED

© Copyright 2009 by Assmann Electronic Components
All International Rights Reserved