

THIS DRAWING IS UNPUBLISHED. RELEASED FOR PUBLICATION AUG. 2006.
 © COPYRIGHT BY TYCO ELECTRONICS CORPORATION. ALL RIGHTS RESERVED.

LDC	DIST	REVISIONS					
		P	LTR	DESCRIPTION	DATE	DRN	APVD
DW	-		B	REVISED (ECR-09-008230)	08APR09	BH	WK
			B1	REVISED PER ECO-09-024606	02NOV09	KK	AEG

NOTE:

- MATERIAL:
HOUSING: PA46, UL 94V-0, COLOR: (SEE TABLE).
CONTACTS: BRASS.
 - FINISH:
CONTACTS: (SEE TABLE) GOLD PLATED ON CONTACT AREA,
2.54um [100u"] MIN. BRIGHT-TIN ON SOLDER TAIL,
WITH ENTIRE CONTACT UNDERPLATED 1.27um [50u"] MIN. NICKEL.
 - PIN-IN-PASTE CAPABLE TO 265°C IN ACCORDANCE WITH TEST SPECIFICATIONS 109-201 AND 109-202.
 - WEIGHT: 14.0 GRAMS
- △ OBSOLETE PARTS: OBSOLETE CIS STREAMLINING PER D.RENAUD/D.SINISI

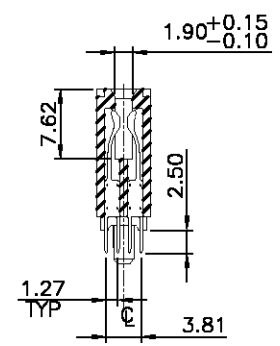
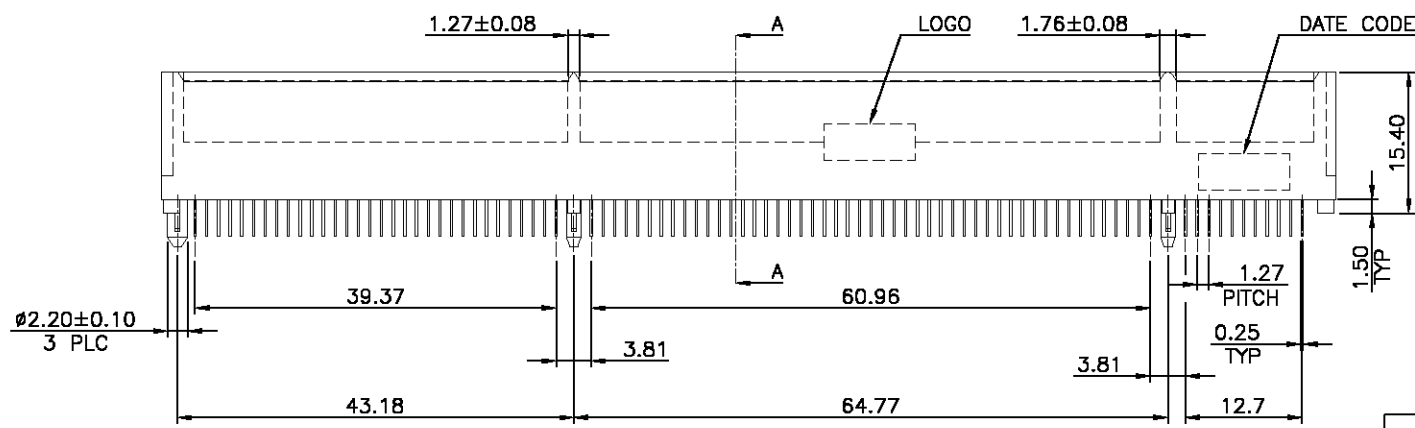
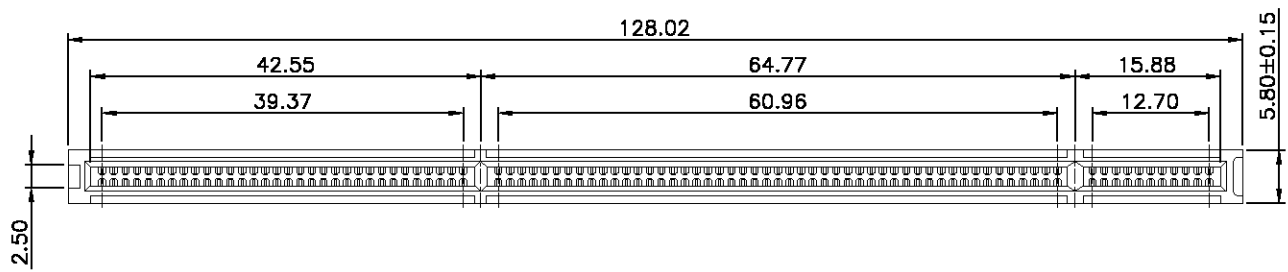

△ OBSOLETE

3.3V	IVORY	0.762μm [30μ"] MIN.	1734425-6
	GREEN (3395C)	0.762μm [30μ"] MIN.	1734425-5
		0.381μm [15μ"] MIN.	1734425-4
		G/F	1734425-3
	IVORY	0.381μm [15μ"] MIN.	1734425-2
	G/F	1734425-1	
VOLTAGE	HOUSING COLOR	MIN.GOLD THICKNESS	PART NUMBER

THIS DRAWING IS A CONTROLLED DOCUMENT.

DIMENSIONS:	TOLERANCES UNLESS OTHERWISE SPECIFIED:
MM	
	0 PLC ± -
	1 PLC ± 0.30
	2 PLC ± 0.20
	3 PLC ± 0.15
	4 PLC ± -
	ANGLES ± 3°
MATERIAL	FINISH
SEE NOTE	SEE NOTE

DRN B. HSING 08APR2009	Tyco Electronics Corporation Tyco Electronics Taipei, Taiwan		
CHK S. CHIEN 08APR2009	NAME		
APVD W. KODAMA 08APR2009	PRODUCT SPEC		
	108-57522		
	QUALIFICATION TEST REPORT		
	501-57597		
WEIGHT 14 GRAMS	SIZE A3	CAGE CODE 00779	DRAWING NO 1734425
CUSTOMER DRAWING	SCALE -	SHEET 1 OF 3	REV B1

THIS DRAWING IS UNPUBLISHED. RELEASED FOR PUBLICATION AUG. 2006.
 © COPYRIGHT BY TYCO ELECTRONICS CORPORATION. ALL RIGHTS RESERVED.

LDC		DIST		REVISIONS			
P	LTR	DESCRIPTION		DATE	DRN	APVD	
		SEE SHEET 1.					

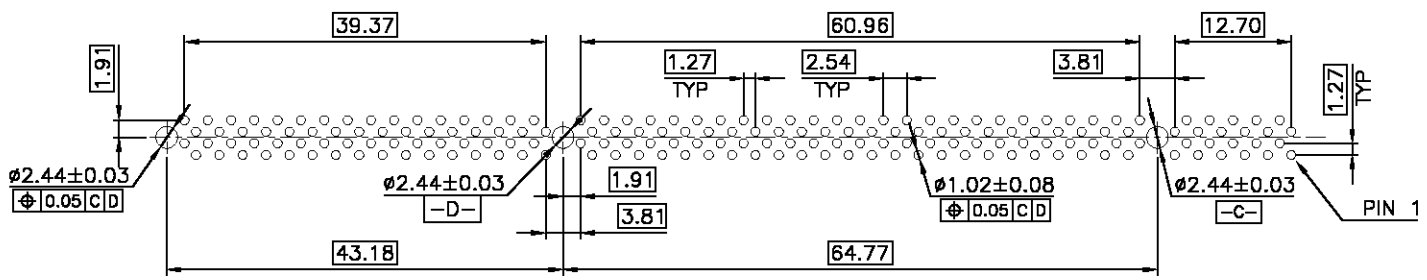

RECOMMENDED PCB LAYOUT (TOP VIEW)
 TOLERANCE: ±0.05, THICKNESS: 1.6mm

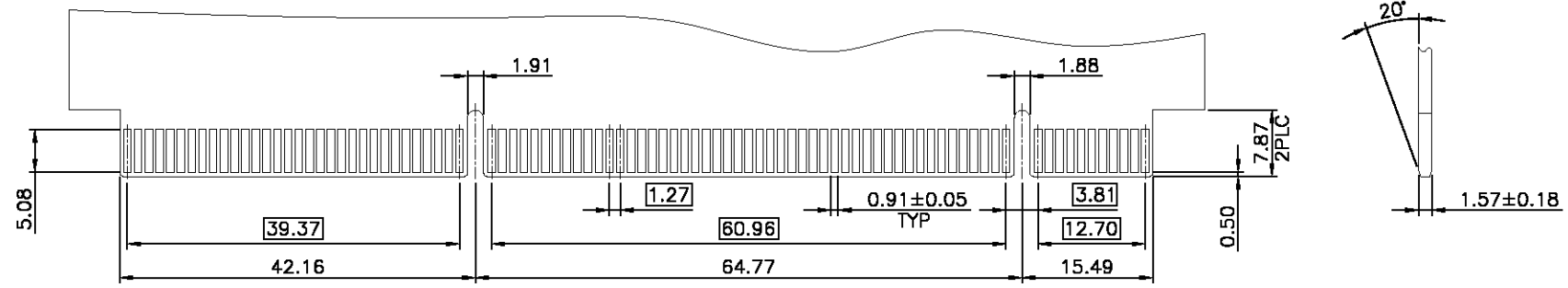

RECOMMENDED MATING PCB LAYOUT
 TOLERANCE: ±0.05mm

THIS DRAWING IS A CONTROLLED DOCUMENT.		DRN	Tyco Electronics Corporation Taipei, Taiwan	
DIMENSIONS: MM		CHK	NAME	
TOLERANCES UNLESS OTHERWISE SPECIFIED:		APVD	CARD EDGE SLIM PCI, 184 POS	
<ul style="list-style-type: none"> 0 PLC ± 1 PLC ± 2 PLC ± 3 PLC ± 4 PLC ± ANGLES ± 		PRODUCT SPEC	SIZE	CAGE CODE
MATERIAL		APPLICATION SPEC	A3	00779
FINISH		WEIGHT	DRAWING NO. 1734425	
		CUSTOMER DRAWING	RESTRICTED TO	
		SCALE	SHEET 2 OF 3	REV B1

THIS DRAWING IS UNPUBLISHED. RELEASED FOR PUBLICATION AUG. 2006.
 © COPYRIGHT BY TYCO ELECTRONICS CORPORATION. ALL RIGHTS RESERVED.

LDC		DIST		REVISIONS			
P	LTR	DESCRIPTION		DATE	DWN	APVD	
		SEE SHEET 1.					

- NOTES:
 1. CORRUGATED BOARD: CORRUGATED, SIZE: 307mm(L)X 127mm(W)X 3mm(H).
 2. INNER BOX : CORRUGATED, SIZE: 325mm(L)X 138mm(W)X 52mm(H).
 3. BOX : CORRUGATED, SIZE: 340mm(L)X 295mm(W)X 295mm(H).
 4. QUANTITY: SEE TABLE.

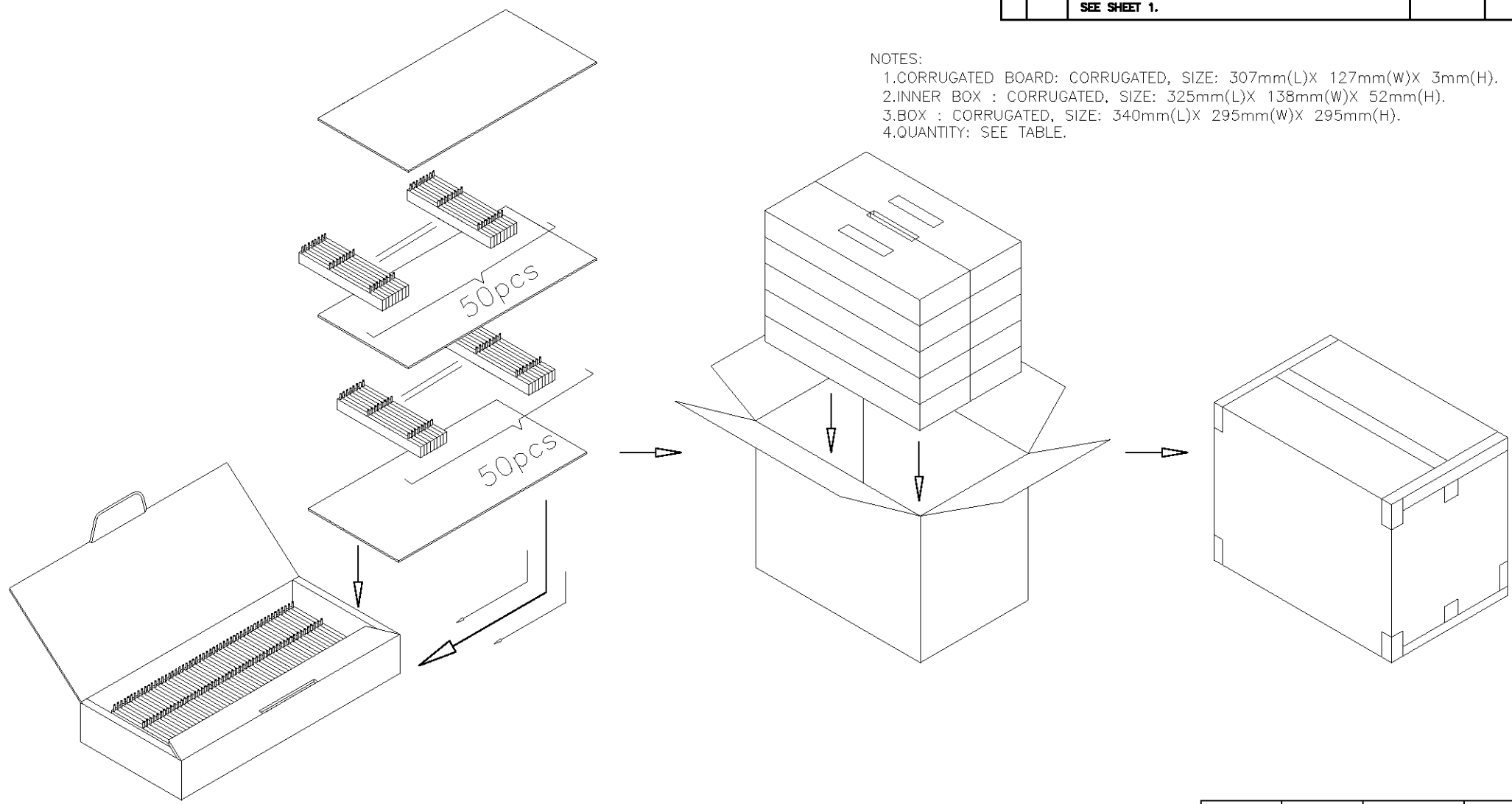

100	1000	14	17
PIECES PER INNER BOX	PIECES PER BOX	NET WEIGHT (Kg)	GROSS WEIGHT (Kg)

THIS DRAWING IS A CONTROLLED DOCUMENT.		DWN		Tyco Electronics Corporation Taipei, Taiwan	
DIMENSIONS: MM		CHK		NAME	
TOLERANCES UNLESS OTHERWISE SPECIFIED:		APVD		CARD EDGE SLIM PCI, 184 POS	
0 PLC ± -		PRODUCT SPEC		SIZE	
1 PLC ± -		APPLICATION SPEC		CAGE CODE	
2 PLC ± -		WEIGHT		DRAWING NO	
3 PLC ± -		CUSTOMER DRAWING		RESTRICTED TO	
4 PLC ± -				A3 00779 C=1734425	
ANGLES ± -				SCALE	
FINISH				SHEET 3 OF 3	
				REV B1	